

## MALM Bed Frame Instructions from IKEA

From Pictures to Words by Travis Graf

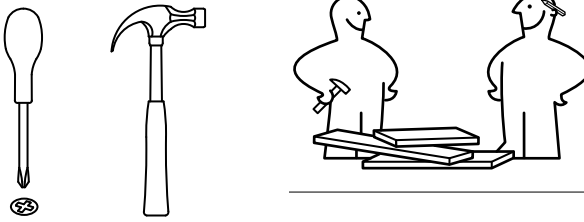

A hammer and a Phillips head screw driver is required for this project. It is recommended to complete this with the help of another person.

### • **STEP 1**

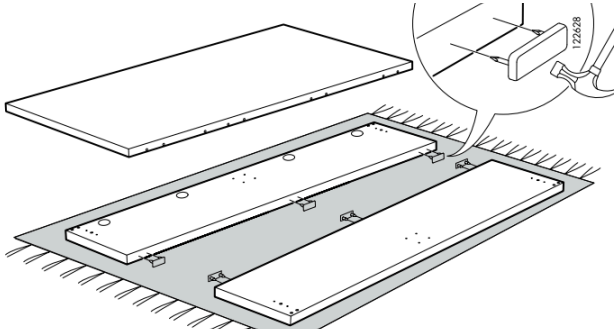

Take the two bottom boards of frame, and lay them back-side up, and gently hammer in floor glides into the fitted holes.

### • **STEP 2**

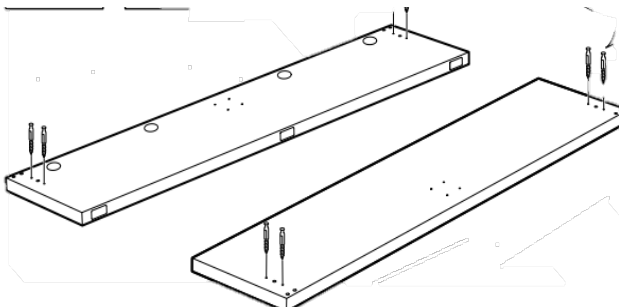

Fasten 8 cam lock screws with included Allen key in designated areas. Make sure to grab screws with Allen key by the base of the cam lock.

### • **STEP 3**

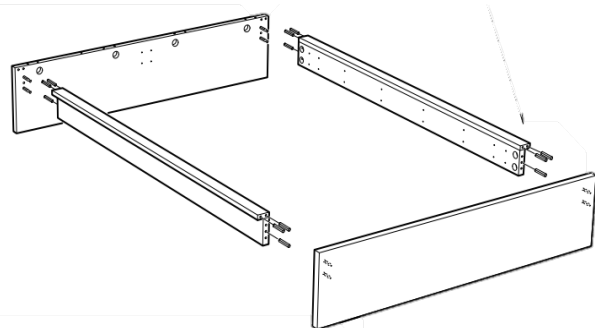

Grab the sideboards of the frame, and insert 3 small wood dowel pegs in each end of the boards. Then connect the sideboards to the front and back facing boards.

### • **STEP 4**

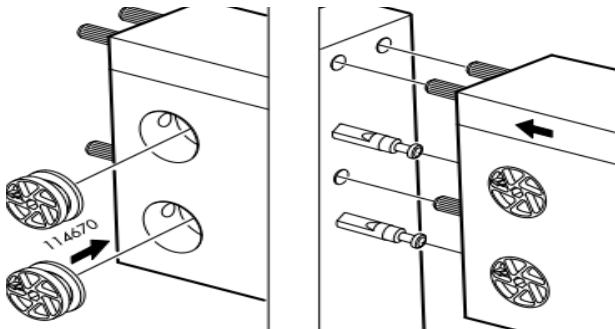

Take 4 cam lock wheels, and insert them to the designated areas on the ends of the sideboards where they connect to the bottom backboard of the bedframe

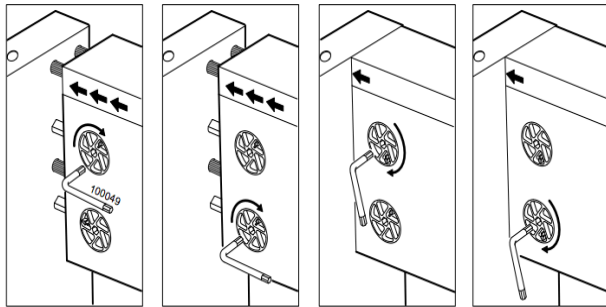

## • **STEP 5**

Take the provided L-Shaped metal hexagon key and tighten the cam lock wheels in place using clockwise motion.

## • **STEP 6**

Take 5 of the large wood dowel pegs, and insert them into the top of the back bottom board of the bed frame.

## • **STEP 7**

Place the backboard of bedframe on a clean, cleared table, and use 4 hanger bolts to screw into place using the narrow tip of provided wrench key.

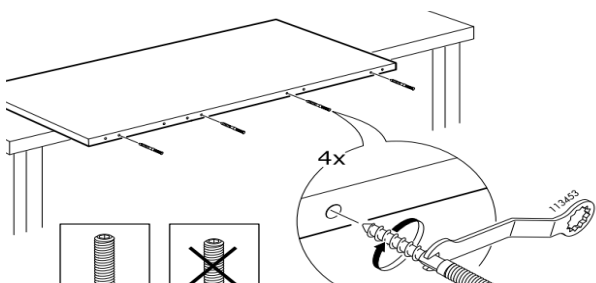

## • **STEP 8**

Take the backboard with hanger bolts facing down, and insert into designated holes on top of the back bottom base board and connecting wooden dowel pegs.

## • **STEP 9**

Take 4 U-wedges, and place over the top of all four openings. Take 4 nuts and place on bottom of the opened screw of bolts. Use opening on wrench to screw into place.

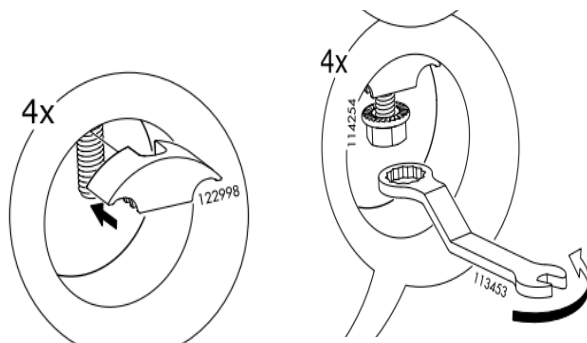

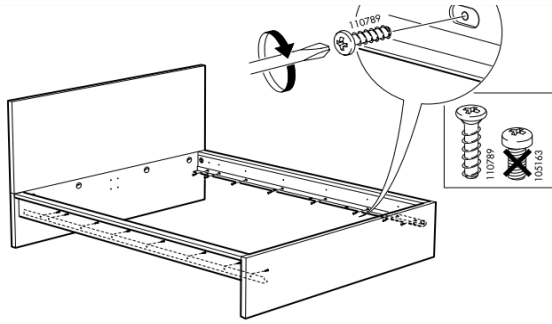

## • **STEP 10**

Screw both support brackets to the inside of sideboards using the large screws. Ensure the support brackets are facing outward, as they will hold the framing for the mattress.

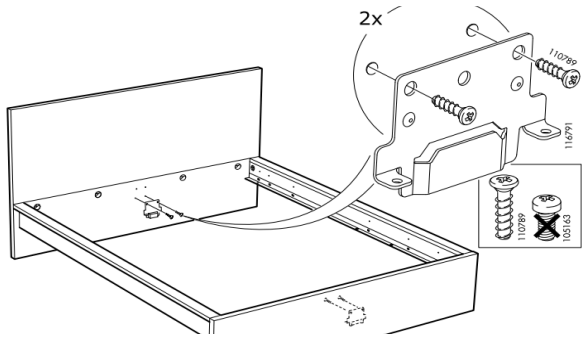

## • **STEP 11**

Screw mounting plates into both bottom boards using the large screws. These need to be screwed in to the inside of the boards.

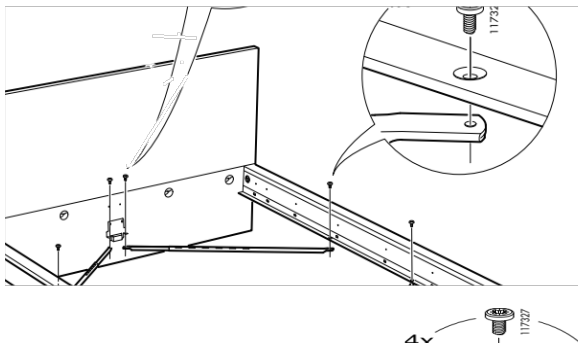

## • **STEP 12**

Using the small screws, take 2 support beams, and screw into place diagonally from the back mounting plate, to the side support bracket. Do the same for the front mounting plate.

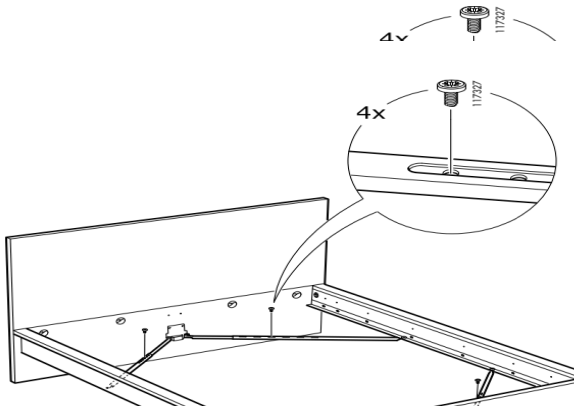

## • **STEP 13**

Using small screws, take one for all 4 support beams, and screw it into the middle to lock in place.

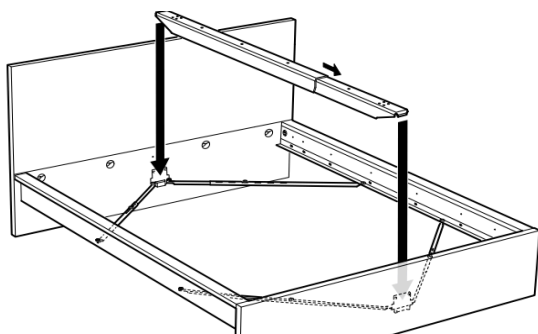

## • **STEP 14**

Take center support beam, and place it on the back mounting plate, and fit it to the front mounting plate.

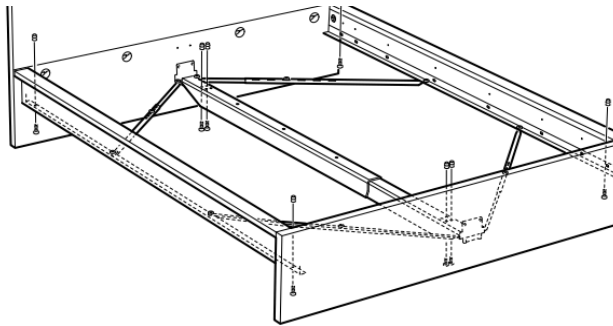

- **STEP 15**

Fasten remaining screws in from the bottom of center support beam and side brackets, and as the screws come in up top, fit them with a plastic sleeve.

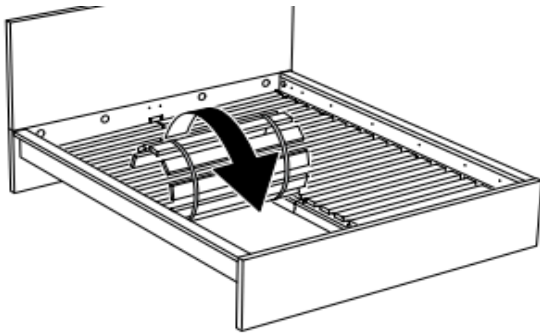

- **STEP 16**

Roll out the wooden slats on each side, and make sure plastic sleeve tipped screws go between slats.